

Modifying the passcode

1. Remove the main body.

Loosen the 2 fixing screws, and remove the main body from the door.

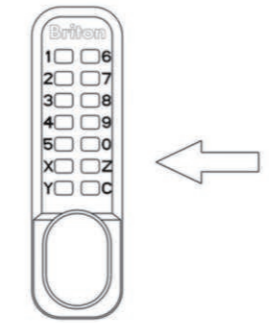

2. Press the "C" button on reset the chamber.

Place the main body on a flat surface (with the code buttons facing down).



3. Remove the panel from the rear of the Back Plate.

Loosen the red screws and carefully remove the rear panel. Ensure springs are held in place on the plate.

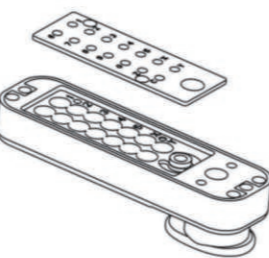

4. Expose the top of the connection pins.

Note: the red tipped code tumblers correspond to the existing code. The "C" button tumbler is not coloured. The blue tipped non-code tumblers fill the remaining positions.

Modifying the passcode

5. Set the new passcode.

Hold the lock in your hand and depress the "C" button. Use forceps to re-position the tumblers to correspond with your new code (insert or replace the red code pins into the corresponding holes, insert or replace the blue connection pins into the non-code positions)

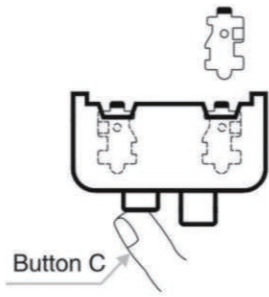

Caution:
DO NOT remove the non-coloured connection pin. Please hold button "C" when removing or assembling code pin. The mechanism may be seriously damaged if above instruction is neglected.

The rectangle shaped hollow part must be positioned outwards, with the coloured tips on top, see diagram below:

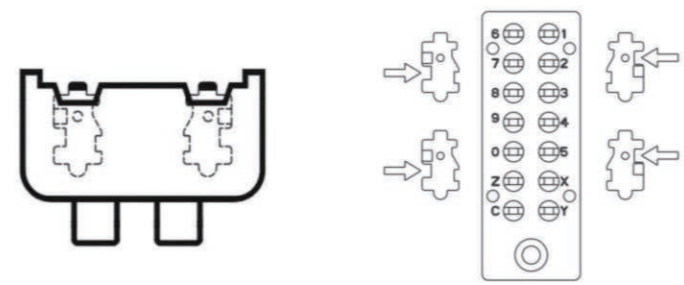

Modifying the passcode

6. Assemble the door lock and write down the new code.

Check all the springs are held in place on the plate and place the rear panel in place. Affix with red screws and write the new code on the Passcode Card.

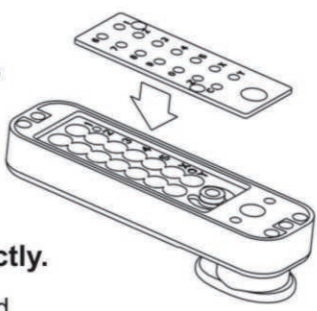

7. Check the new passcode works correctly.

Press "C" button, input the new passcode and turn the knob, repeat to ensure the unit works correctly.

8. Re-install the lock onto the door.

Position the lock onto the door with the 2 fixing bolts, ensuring the lock shaft is kept at the correct direction. Please refer to "Spindle positioning".

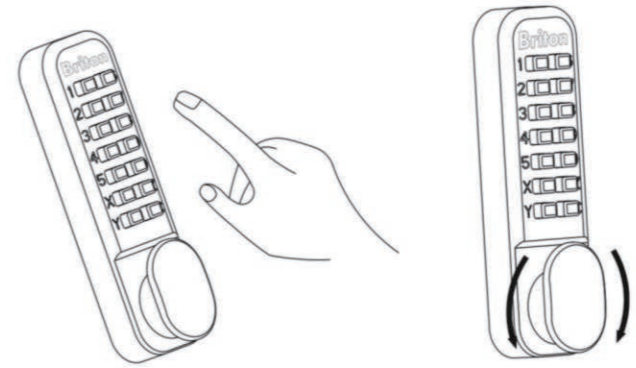

Digital Mortice Locks

INSTALLATION & CODE CHANGE

INSTRUCTIONS

Freephone Helpline:
0800 834 102

Allegion UK Ltd
Tel: +44 (0) 121 380 2400
Technical Tel: 0800 834102
www.allegion.com/uk



Box contents

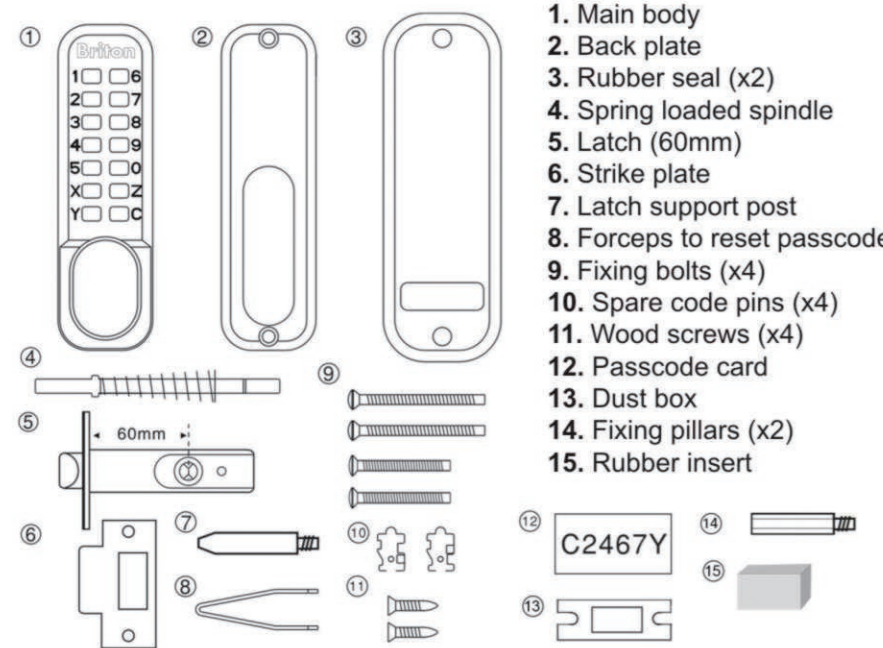

Door handing

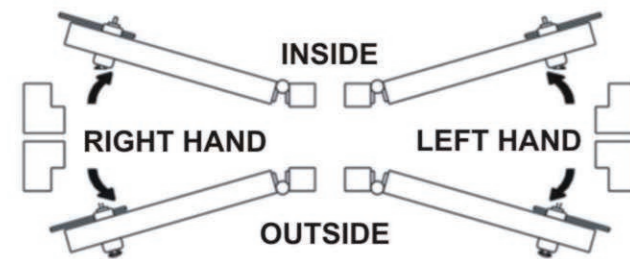

Viewed from outside, a door is right handed if the hinges are on the right, and left handed if the hinges are on the left.

Applying the template

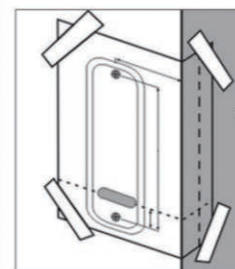

1. Fold the template along with fold line and tape it to the door.
2. Mark the 13mm hole, 3 x 8mm holes and the centre line of the latch onto one side of the door. Reverse the template and apply the template to the other side of the door lining up the centre line and mark the 4 holes as above.
3. Keep the drill level and square to the door, drill holes from both sides to avoid splintering.

Positioning the latch

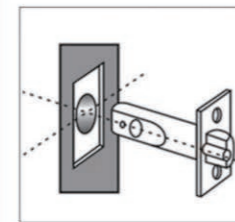

1. Mark the central point on the 'central line of latch' on the door edge.
2. Drill a 25mm hole at 85mm deep.
3. Insert the latch and draw around the faceplate.
4. Remove the latch and cut out a 3mm rebate so the face plate fit flush with the door.
5. Secure the latch to the door with wood screws.

Latch support post

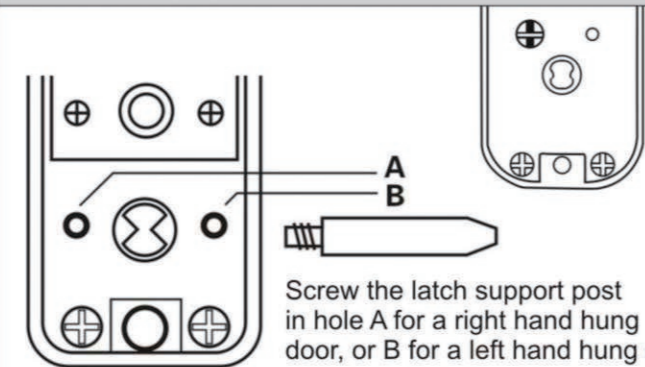

Screw the latch support post in hole A for a right hand hung door, or B for a left hand hung door.

When fitting a Back Plate to a left-handed door the Blue screw must go in the right-handed hole and vice versa.

Spindle positioning



The spring loaded spindle will fit doors between 35mm and 60mm thickness. Cut the spindle to adjust the length to suit the door thickness.

Fitting the lock

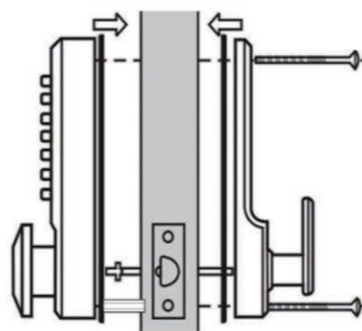

Screw the fixing pillars into the top and bottom fixing holes of the main body.

Hold the main body and the Back Plate in place with the rubber seals and spindle in position.

Use the fixing bolts to screw the main body and Back Plate together. Do not tighten until lock is vertical on the door. Test the mechanism to ensure it is working correctly.

DO NOT CLOSE THE DOOR UNTIL YOU ARE SURE THE LOCK WORKS CORRECTLY.

DO NOT over tighten the fixing bolts as this may cause distortion and lead to poor operation.

Fixing the strike plate

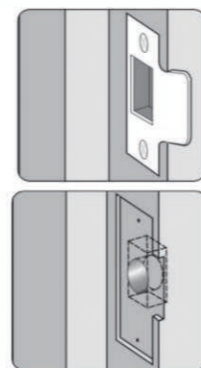

Position the Strike Plate on the door so that it lines up with the flat of the Latchbolt. NOT THE PLUNGER.

Mark the inner and outer edges of the Strike Plate and cut a rebate so it fits flush against the door frame. Drill out the recess for the dust box.

Fit the Dust Box and Strike Plate with one Wood Screw first to ensure it is positioned accurately. The latchbolt but not the plunger should enter the aperture easily and be held without too much 'play'. When satisfied, secure the Strike Plate with the second screw.

NB. The plunger beside the latchbolt deadlocks the latchbolt and protects against manipulation. IT MUST NOT enter the Strike Plate aperture when the door is closed.

Hold open function

Removal of Hold Open Slider

If required it is possible to remove the hold open function:

1. Remove the Fixing Plate by removing the 4 screws on the rear of the inner Backplate.



2. Lift off the plate and remove the "hold open slider part".

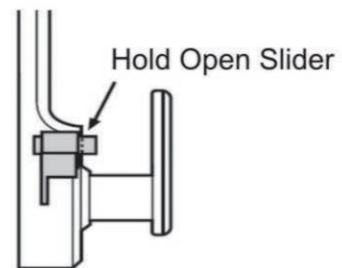

3. Fit the Rubber Insert to fill the aperture in the Backplate.

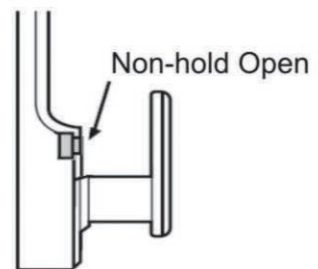

NOTE: Do not remove the blue handing screw.

