

1. Ensure door height suitable to meet required 17mm – 19mm.
2. Measure width between the door frames and cut the threshold to fit neatly, check ends around the door stops 'Y'. Insert the lower gasket seals on the underside of the bar and the EPDM arch seal into one grooved. Screw down fully and use sealant at the ends.
3. Press home seal into the other grooved ensuring contact all along its length.
4. (a) For heavier traffic embed the threshold in cement mortar.  
(b) If the gap under the door is too large fit a strip of wood to the door bottom.  
(c) Replacement seals are available.

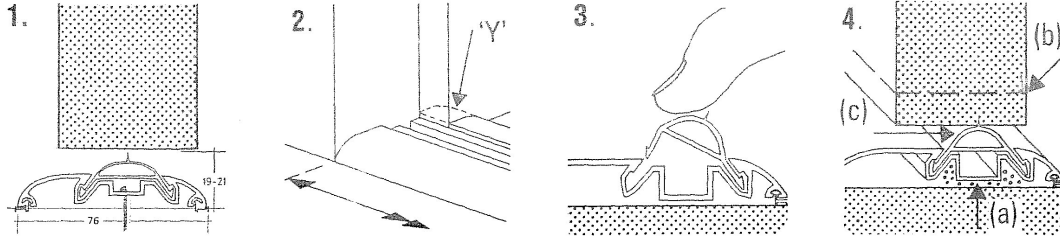

1. Ensure door height suitable to meet required 17mm – 19mm.
2. Measure width between the door frames and cut the threshold to fit neatly, check ends around the door stops 'Y'. Insert the lower gasket seals on the underside of the bar and the EPDM arch seal into one grooved. Screw down fully and use sealant at the ends.
3. Press home seal into the other grooved ensuring contact all along its length.
4. (a) For heavier traffic embed the threshold in cement mortar.  
(b) If the gap under the door is too large fit a strip of wood to the door bottom.  
(c) Replacement seals are available.

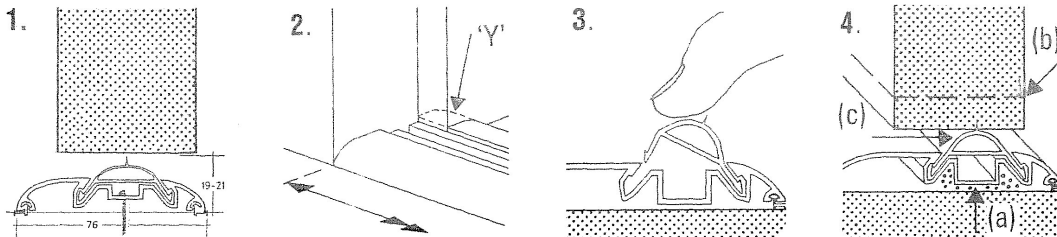

1. Ensure door height suitable to meet required 17mm – 19mm.
2. Measure width between the door frames and cut the threshold to fit neatly, check ends around the door stops 'Y'. Insert the lower gasket seals on the underside of the bar and the EPDM arch seal into one grooved. Screw down fully and use sealant at the ends.
3. Press home seal into the other grooved ensuring contact all along its length.
4. (a) For heavier traffic embed the threshold in cement mortar.  
(b) If the gap under the door is too large fit a strip of wood to the door bottom.  
(c) Replacement seals are available.

